

Installation Guide for Durapalm Panels



Table of Contents

1. GENERAL DESCRIPTION:	3
1.1 PRODUCT DESCRIPTION:	4
1.1.1 TROPICAL MOTIFS PANELS	5
1.1.2 LINEAR PROFILES	6
1.1.3 ACOUSTIC SYSTEMS	7
1.1.4 ACOUSTIC SYSTEMS	8
1.2 PANEL SIZING & DIMENSIONAL CHANGE:	9
1.3 SITE CONDITIONS, STORAGE & HANDLING:	9
1.3.1 PACKING:	9
1.3.2 INSPECT UPON DELIVERY:	9
1.3.3 STORAGE:	9
1.3.4 ACCLIMATIZATION:	10
1.3.5 MAINTAIN ADEQUATE ENVIRONMENTAL CONTROLS:	10
1.4 COLOR:	10
2.0 WORKING WITH PANELS:	11
2.1 TOOLS & CUTTING THE PANELS:	11
2.2 PANEL ARRANGEMENT FOR CONSISTENT COLOR:	11
2.3 PANEL ALIGNMENT FOR CONSISTENT PATTERN:	11
2.3.1 TIPS FOR ALIGNMENT OF MULTIPLE PANELS:	12
2.3.2 TIPS FOR VERTICAL ALIGNMENT OF MULTIPLE PANELS:	13
3. INSTALLATION EXAMPLE USING THE MONARCH® Z CLIP SUSPENSION SYSTEM:	18
3.1 GENERAL INSTALLATION NOTES:	18
3.1 MONARCH® Z-CLIPS – SUSPENSION INSTALLATION SYSTEM:	18
3.2 INSTALLATION TIPS FOR MONARCH® Z-CLIPS:	22
3.3 PROVIDING ADEQUATE STANDOFF FOR SOUND ABATEMENT APPLICATIONS:	22
TIPS FOR HORIZONTAL PANEL INSTALLATION:	24
ADDITIONAL SUPPORT FOR HORIZONTAL JOINTS:	24
4. TRIM OPTIONS FOR WALLS AND CEILINGS	25

1. General Description:

Durapalm® paneling systems are manufactured by Smith & Fong Co. and offered in various configurations to suit various wall and ceiling installation requirements. The architectural panels are characterized by various patterns milled into the face ply of the panels, exposing the panel's core layer, creating a fascinating visual and tactile pattern through the juxtaposition of the core and surface layers of the panels.

These architectural panels are manufactured using palm and bamboo plywood, our proprietary 3-ply panels manufactured to meet stringent specifications for wall and ceiling applications.

Taking advantage of bamboo's innate strength and flexibility, these Durapalm® wall and ceiling paneling systems have been well received by architectural and design professionals since their introduction in 2012. Our panels have been specified and installed in numerous locations and have quickly become known for their inherent aesthetic and functional qualities, having already garnered numerous industry awards and recognition.

This guide is intended to help provide basic details and characteristics for each type of panel design, with general guidance for installation and use of the panels. We also discuss one commonly used installation method using cleats in a suspension system that is intended to accommodate movement in these flexible panels. A suspension system, like the Monarch® Z-Clip system that is discussed here for example, typically works much like any other French cleat to accommodate an installation without screwing into the face ply of a panel. Though many customers prefer installation with French cleats due to its inherent visual and structural effectiveness, numerous other installation systems may be utilized at the discretion of the installer to choose the correct fastener type for the installation subject to job requirements.

We provide this advice for use at your discretion, but our advice is neither intended nor should be used as a substitute for an architect's or engineer's plan, in particular because our advice is based on general information and cannot take into account the unique requirements or conditions for each installation, including for example actual on-site conditions, local building code requirements, and all other applicable requirements that may be applicable to a particular installation.

1.1 Product Description:

All Durapalm panels described here are generally known as Acoustic Systems, Linear Profiles, and Tropical Motifs, with the product group referred to as Durapalm Wall Systems (DWS)

All Durapalm panels are manufactured of palm veneer over a 100% bamboo core, typically using bamboo plywood, with the palm and bamboo plywood products featuring a bi-directional core that is specially selected for visual consistency through the core layer.

Our panels typically feature design patterns carved into the face ply, with relief cuts on the back side of the panel to provide balance and allow for flexibility. This design permits DWS panels to deflect from flat across the width or length of the panels. Our DWS panels can be quite flexible, with the degree of flexibility varying with the design, with some panels being flexible enough to easily accommodate many unusual installations, including to wrap around columns or other curved support surfaces. Nevertheless, the same DWS panels are also designed to snap rigid and flat when properly installed using appropriate fasteners.

Upon receipt, you should note that the panels will not be perfectly flat, and as explained further in Section 1.3.3. on panel "Storage", the panels in fact may have some residual tension, causing them to bend or curl and not lay flat out of the box. This is part of the inherently flexible nature of the panels, with the panels intended to snap flat upon installation using an appropriate fastener system.

1.1.1 **Tropical Motifs** panels are carved with dramatic patterns aggressively carved into the face or top layer of the panel. Because of these bold designs, the panels feature striking visual presentations with much of the face layer removed to expose the bamboo core layers to create a striking presentation.

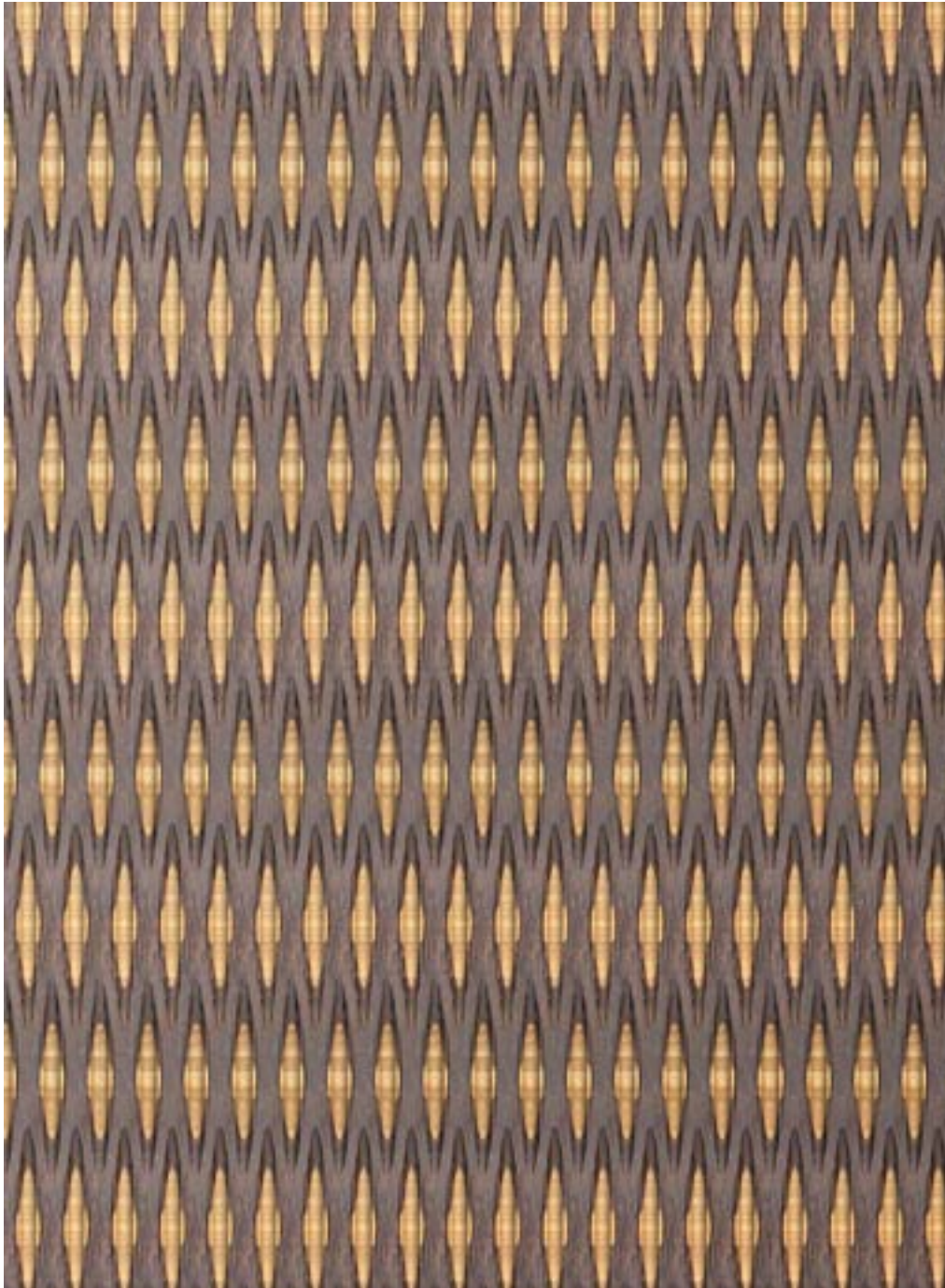

**Tropical Motifs,
Style -Tonga**

The face ply of Tropical Motifs panels are carved with deep patterns, with a shallow grid milled into the back of the panels to relieve strain. Because so much of the face ply is removed during carving, the panels can readily respond to changes in ambient environmental conditions.

1.1.2 **Linear Profiles** panels feature carved lines of various thickness running the length of the panels, cutting down to the bamboo core to reveal the bamboo grain pattern. These panels juxtapose the subtle texture and grain pattern of the bamboo core with the dramatic grooves carved into the palm face ply, harmonizing the structured vertical grooves with the palm grain pattern while creating a subtle contrast between the patterns. Because these are repeating patterns, a consistent, seamless pattern can be achieved across multiple panels when installed properly.

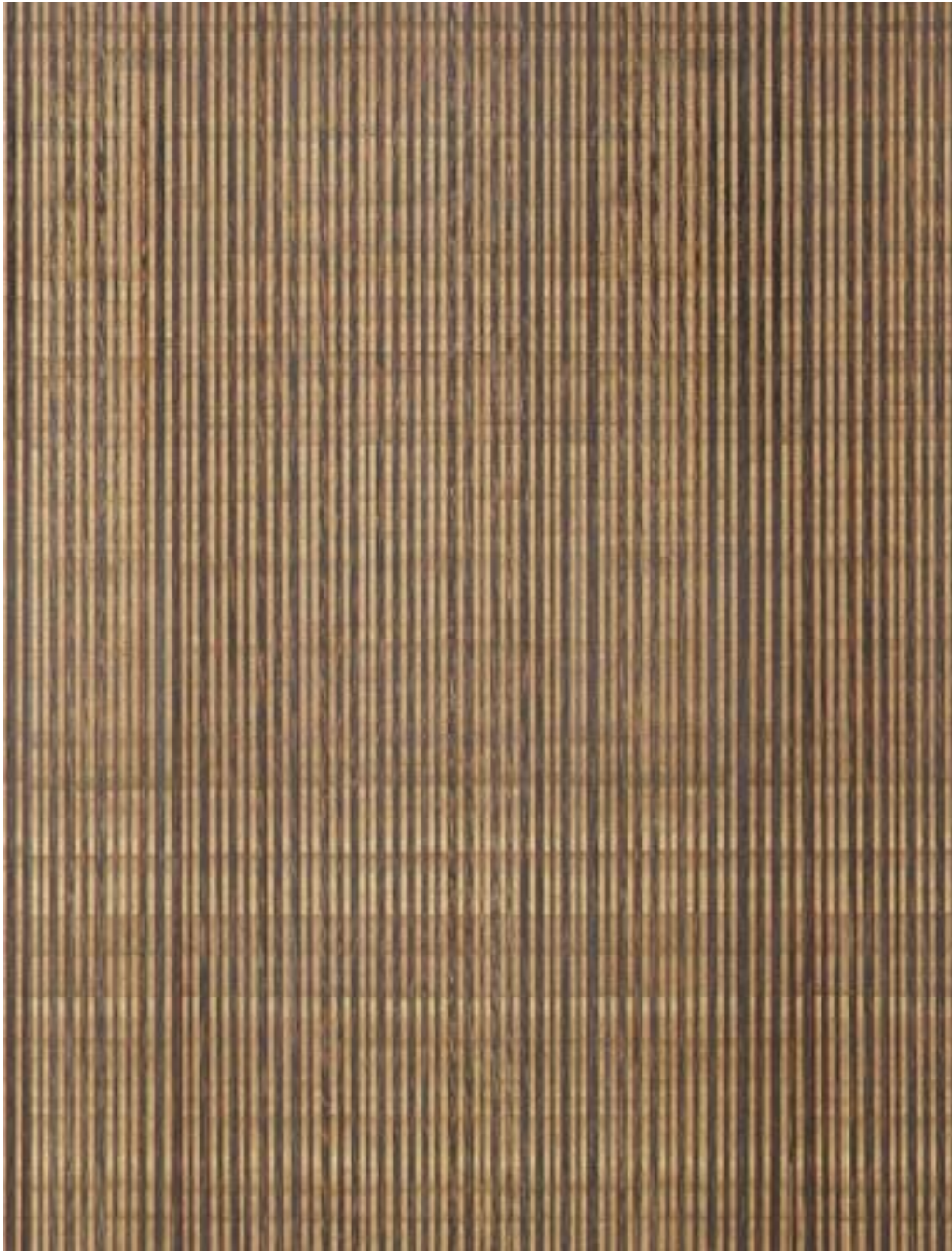

Linear Profiles, Style-Mandalay

1.1.3 **Acoustic Systems** panels feature perforations through the panel so that sound waves can travel through the panel and be dissipated by the backing material. We offer a compatible 1" thick fiberglass sound attenuation backing material for this type of acoustical abatement, and when installed with this type of backing material, the panels provide significant sound attenuation qualities.



Acoustic Systems,
Style- Rajasthan

Please note that the perforations in these panels may visually expose portions of the supporting installation hardware (e.g., Monarch® Z clips or similar). Hardware should be painted black or wall color to minimize visibility. Additional installation room behind the panel should be provided when using sound absorption backing material.

1.1.4 **Acoustic Systems** panels, such as the **Tahiti , Marrakesh and Sandakan styles**, have a similar grooved pattern to the Linear Profiles, but with the grooves running the length of the panel undulating in height as they carve into the core layer. Additionally, to help with sound attenuation, the panels also feature perforations through the panel in varying but regular patterns. These carved patterns repeat across the panel for a consistent pattern across multiple panels when arrayed and installed properly.



Acoustic Systems,
Style - Sandakan

The juxtaposition of the palm grooves and the perforations, arrayed against the subtle bamboo pattern of the core layer, creates a dramatic visual moiré pattern. Because of the intricate and extensive millwork in these panels, the panels are quite flexible across the width of the panels, and indeed may even be installed along gentle curves.

1.2 Panel Sizing & Dimensional Change:

Our panels are typically offered in a nominal 1.213m x 2.432m but are also available in other custom sizes to suit your particular installation needs. ****Please contact us with your inquiries for custom sizing of any panel.****

Because of our use of computer numeric control (CNC) manufacturing processes, we maintain dimensional control over the panels through the manufacturing process, and further perform quality control checks at several steps of the manufacturing process to assure correct sizing. Nevertheless, because of the hygroscopic tendencies of wooden products, it is imperative that panels be stored in appropriate environmental conditions and be protected against dimensional change caused by seasonal variations in ambient environmental conditions.

If you encounter excessively low relative humidity, resulting in panel shrinkage, please consider using an appropriate reveal between panels. Architectural Woodwork Institute (AWI) standards reference a 1.6mm reveal for use in panel installation, and the use of a 1.6mm reveal between panels should not affect panel visual performance while allowing for adequate dimensional change as relative humidity varies through various seasonal changes.

1.3 Site Conditions, Storage & Handling:

1.3.1 Packing: Your panels are packed on an oversize pallet, with each panel surrounded with a 25.4mm thick perimeter of packing hardboard or OSB helping to prevent damage to the panels while in transit.

PLEASE NOTE: Damage to the packing hardboard or OSB material is not a cause for rejecting the pallet as the panels are most likely perfectly fine and protected inside.

1.3.2 Inspect Upon Delivery: Given our extensive packaging, damage to our panels should be rare, but please carefully inspect your package and carefully note any damage during shipping. Upon receipt of the panels, please promptly open the shipping pallet and inspect the panels. If you notice damage to any panel, please notify us immediately of this damage. Please also note to the carrier and write damaged on the waybill or transit documentation given to you by the carrier. To make a claim under the limited warranty applicable to these panels, we require that notice of any defect, or damage during shipping, must be provided to Smith & Fong within 14-days of receipt.

1.3.3 Storage: Panels should always be stored in a dry, clean, and temperature-controlled environment. Please do not allow panels to be stored outside or exposed to exterior environmental conditions because any such exposure to outside environmental conditions will void your limited warranty.

It is best to store the panels in the original factory pallet packaging in a flat horizontal position. Do not expose the panels to extreme temperatures or sources of moisture, and do not store in unconditioned spaces with humidity exceeding 55% or lower than 35% RH, or temperatures lower than 13°C or greater than 30°C.

Many of these panels, and in particular the panels with aggressive face-ply carving such as the Tropical Motifs panels, will tend to curl, or deflect from flat, in response to ambient environmental changes. Once this type of movement has started, the force necessary to correct it will be significantly greater than the force required to keep them flat in the first place. As such, please store these panels in the original pallet, and if necessary, with suitable weight on top to help keep the panels flat prior to installation.

1.3.4 Acclimatization: For a successful installation, it is vitally important that the installation site be fully enclosed, with HVAC running, and acclimatized to the ambient temperature and humidity conditions that will be prevailing once the space is occupied. This is one of the most important criteria for having a successful installation, and one of the most common reasons for a failed installation.

All windows and doors should be in place in the installation space, with all HVAC systems installed and operable to maintain proper indoor temperature and humidity conditions before, during, and after installation of the panels. Whether at the job site or in the millwork shop, our panels should be stored in and acclimatized in spaces once the building is wholly enclosed and HVAC systems continuously functioning.

To acclimatize the panels to the site conditions, you must maintain an indoor environment between 55 - 85°F (13 - 30°C), and relative humidity of 35% - 55%, for a minimum of 7 days prior to installation, with such conditions maintained following installation.

1.3.5 Maintain Adequate Environmental Controls: Like all wood products, our panels are hygroscopic in nature and, depending on the ambient environmental conditions, can readily absorb, retain, and dissipate moisture. Such wooden products undergo dimensional change, expanding with absorption, and shrinking with dissipation of moisture. Because of this hygroscopic characteristic, maintaining adequate environmental controls is one of the most important factors affecting the performance and service life of these panels.

Please avoid all contact with moisture, and immediately dry any panel surfaces that has come in contact with moisture. Similarly, avoid contact with heat sources, such as lights or HVAC registers, as direct heat will damage the panels.

1.4 Color

Our panels are typically available in several solid and duotone colors and can be finished with natural oil or water based finishes. We can also provide many finishes that are customer specified to match architectural control samples.

Please check your panels for color and tone when you receive them. Variations in color and tone, as well as in grain, are typical to wooden products. Please take care to arrange and install your panels while considering maximal visual consistency through the panels' arrangement. Please note that like other natural products, our panel products tend to darken over time as they are exposed to sunlight.

2.0 Working with Panels

2.1 Tools & Cutting the Panels: Our panels must be cut with an 80 Tooth Carbide blade, or better. To avoid blow-outs (e.g., while crosscutting a panel) please raise the saw blade allowing the blade to cut down on the panel. Please take care to cut the panels slowly. Touch up with a natural oil/ finish that can be purchased directly from Smith & Fong to address any edges as needed.

For visible cuts, for example cutouts for outlets or switches, we recommend the use of a spiral saw (e.g., a Roto Zip) which can make both plunge cuts as well as cuts in from the edge of a panel, with typically clean and neat resulting edges.

Please always exercise all proper caution when working with power tools, including to protect against environmental hazards such as airborne dust.

2.2 Panel Arrangement for Consistent Color: Because of natural variations in color and grain, our panels may exhibit color or grain variations from one panel to the next, or one production lot to the next. Further, panels are often ordered in various lots, and the finish may vary by lots.

Prior to installation, we recommend that you arrange the panels on the installation surface based on your personal preferences to minimize the visual appearance of any such natural variation. To further help provide consistency across various lots, please order the entire job, if possible, at one time, or notify us of panels being installed to match a previous finish run. If you feel you have the wrong color, or if your panels have an error, please notify us immediately, and in all events within 14-days of receipt of panels.

2.3 Panel Alignment for Consistent Pattern: Please carefully note that our panels have defined top, bottom, left, and right edges, and will need to be accurately oriented for proper installation. This is vitally important in the case of some panels that are intended to affect a repeating, seamless pattern when installed properly (e.g., Acoustic Systems panels such as Tahiti, Marrakesh, and Sandakan styles.)

To help you define proper orientation for the panel, our production team will mark a small X on the back side of each panel to identify the top of that panel. Proper orientation is of vital importance for achieving a seamless pattern, and proper orientation must be maintained to successfully align a repeating pattern for ceilings and walls.

Referring to the Tahiti, Marrakesh, Sandakan (Acoustic Systems) panel styles for illustrative purposes, please see **Diagram 1** for an illustration of how the panels are “X” marked to help identify proper orientation. To identify the top orientation for the panel, first identify the small X marked on back of the panel. The top X should be joined to a non-X bottom and so on, creating a smooth undulating flow of the panel cores.

DIAGRAM 1



2.3.1 Tips for Alignment of Multiple Panels: the orientation of panel patterns will not be obvious when standing close to a panel. To check pattern alignment from panel to panel (e.g., no X is present or has been cut off) please stand panels side to side, step a few feet back to allow the pattern wavelength in the valley to become obvious.

In panels with patterns that are intended to repeat seamlessly across panels, we highly recommend taking the appropriate time to unpack two or more panels and to line them up for a side-by-side evaluation and trial arrangement until a seamless panel placement is identified with the high and low patterns arranged in a fluid and continuous pattern across panels (with the high pattern corresponding to the peak of the wave form feature of the panels, and low pattern corresponding to the valleys of the wave form feature of the panels.)

Please note that when the identified left- and right-side of a panel are reversed, the fluid wave

pattern of the design would be interrupted. As such, it is very important to keep the panels aligned and consistent with the pattern running left to right upon installation. These panels display various rolling high and low lines to create their distinctive visual effects. It is important that the panels are arranged in a way that side to side you have an alternating valley (low) and peak (high). Regardless of the origin of the panel starting on a high peak or a low valley, you never have a double up, side by side of two lows or two highs. If you notice such an arrangement, your panels will need to be realigned to achieve proper installation as shown in **Diagram 2** below.

Circle shows two 3.2mm outer high edges forming 6.35mm joint



DIAGRAM 2

We recommend against cutting the edges of panels to remove the 3.2mm high ribbing because this high ribbing is specifically provided as a transition element to the next panel, forming a seamless installation at the joints when properly installed. Removal of this 3.2mm high edge allows the panel to dive down under the next panel creating an obvious and unsightly seam.

2.3.2 Tips for Vertical Alignment of Multiple Panels: When arrayed vertically, the top and bottom panels with repeating patterns are joined as high-high and low-low so that the undulation of the wave pattern is continuous, uninterrupted. When aligning a top panel to a

bottom panel the pattern should meet high to high before continuing to a low to low alignment between the top and bottom panels, hence allowing a fluid and undulating rolling pattern vertically up and down, and horizontally across multiple panels. Please see [Diagrams 3 and 4](#) below for an illustration of how the panels should be vertically oriented in this way.

DIAGRAM 3

Correctly aligned
Top right Top left

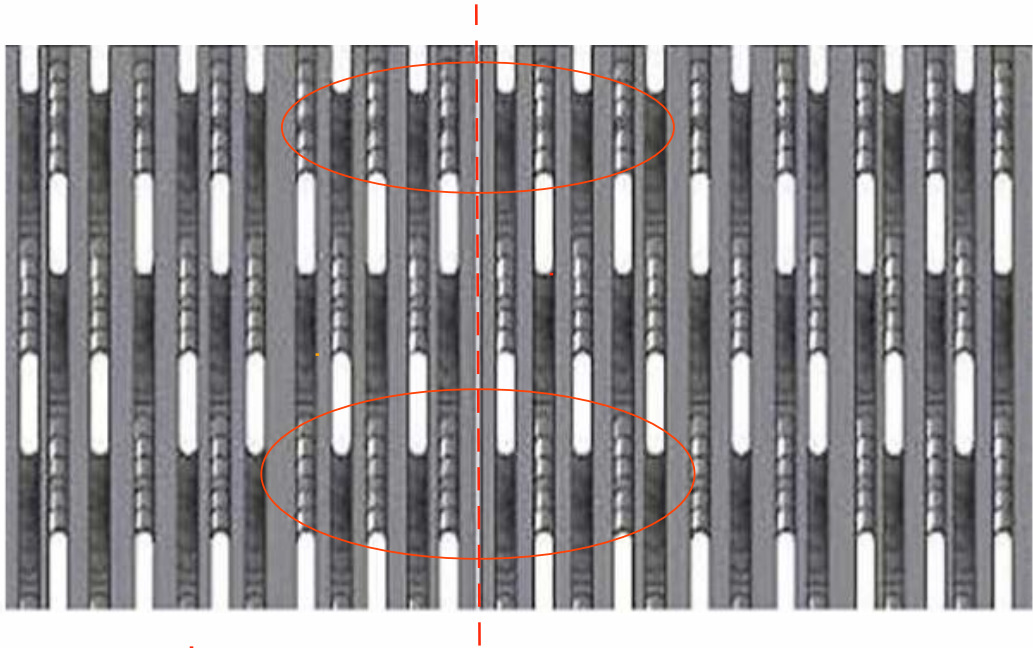
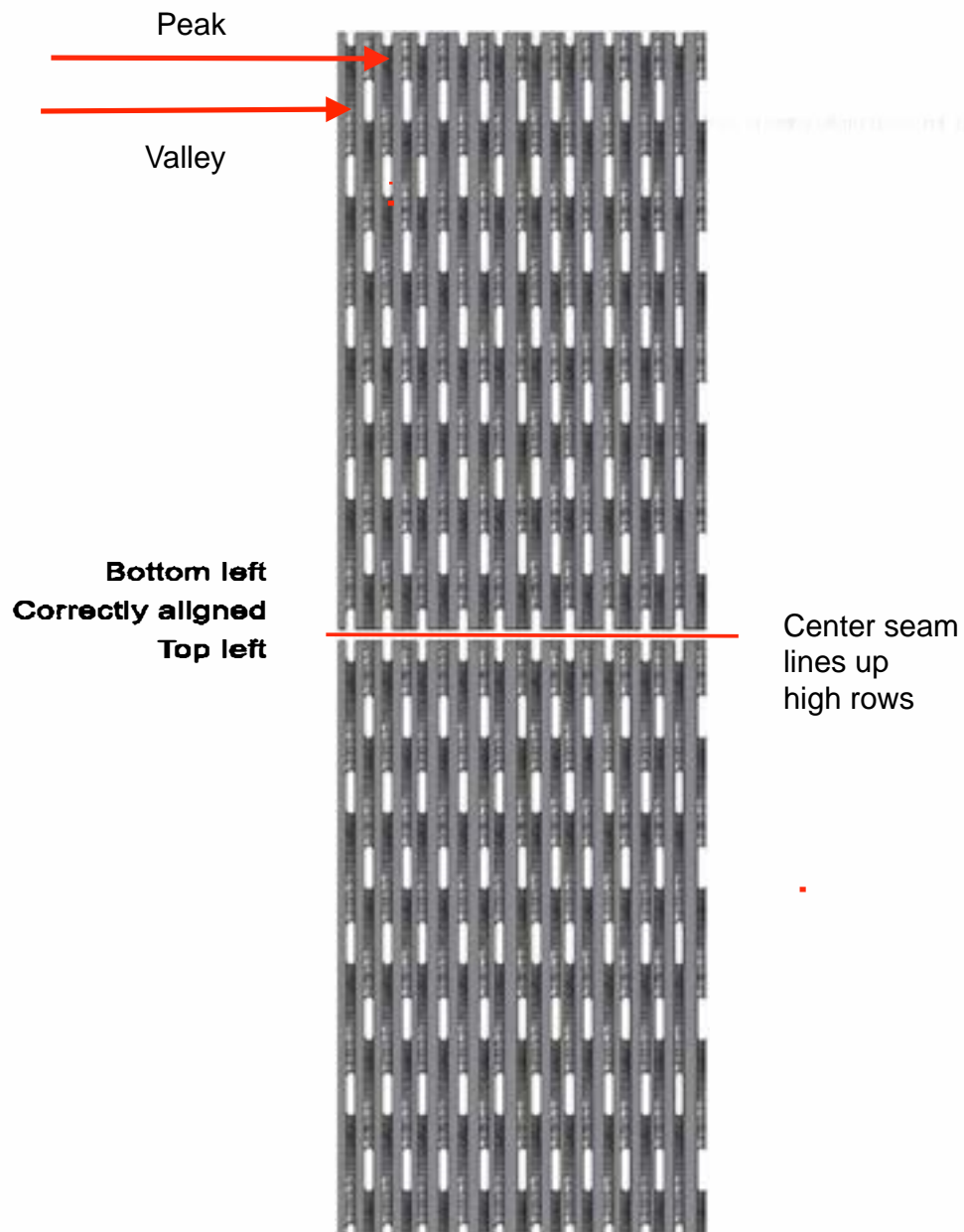

DIAGRAM 4



When joining a high (peak) top to a low (valley) bottom, your panel is likely rotated 180 degrees. Your panel will look odd as it will not continue the gently sloping wave forms in high to high sloping form, but display an abrupt jump from high to a low.

Please see [Diagrams 5 and 6](#) for illustrations of incorrect panel alignments that must be avoided.

DIAGRAM 5 – Incorrect Alignment Example

**Top right
Incorrectly aligned
Top left**

The high (peaks) and low (valleys) are not aligned

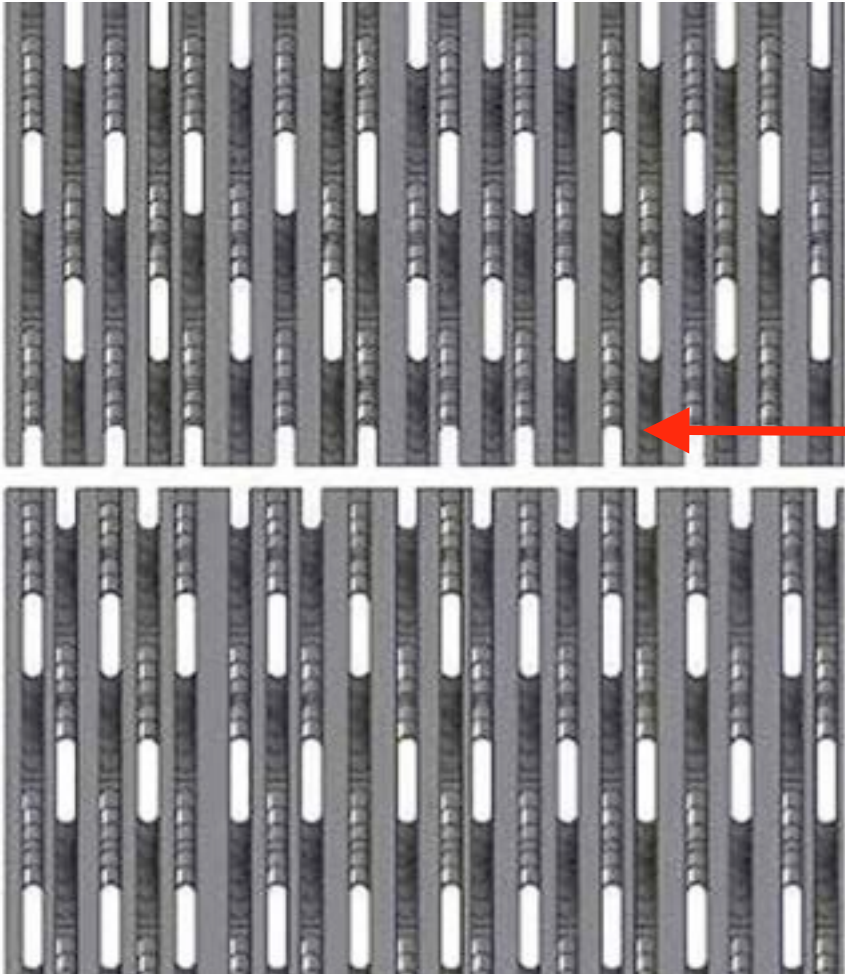
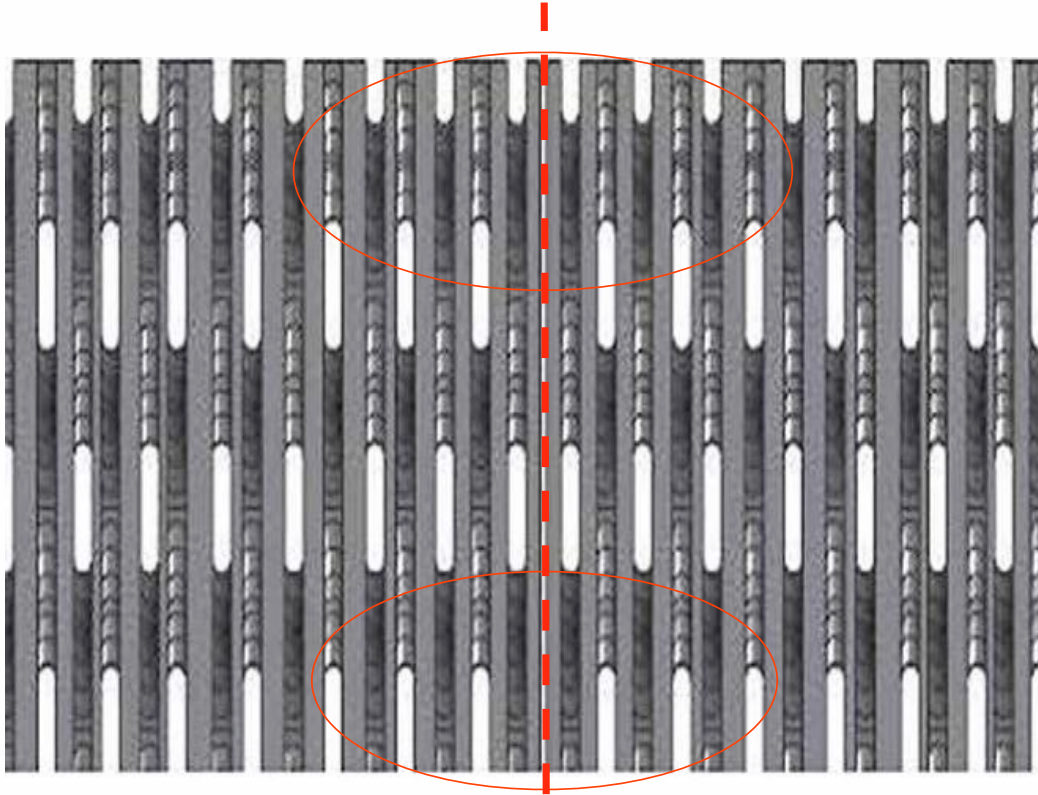

DIAGRAM 6 – Incorrect Alignment Example

Incorrectly aligned
Bottom left Top left



Center seam must line up peak and valley rows or it doesn't work

3. Installation Example Using the Monarch® Z Clip Suspension System

3.1 General Installation Notes: Durapalm panels are made of palm and bamboo, and pound for pound, have a higher tensile strength than steel. Any installation system that you use must be SECURELY ATTACHED TO THE WALL PANELS AND PROPERLY MOUNTED TO WALL STUDS OR OTHER STRUCTURAL MEMBERS CAPABLE OF SUPPORTING THE WALL PANELS.

Never attempt any installation by simply gluing the panels to the wall surface. Prior to installation, please assure that your installation surfaces are true and flat and can support the architectural wall paneling installation. If your wall surfaces are not flat, consider using furring strips or the like to make sure the panels are installed on a uniformly even and flat surface.

Durapalm panels may be installed using any number of fastener types, including mechanical fasteners such as screws, or suspension type installation systems such as French cleats and the like. We generally defer to installers, architects, and other parties responsible for rendering installation services for the ultimate choice of fasteners because of their greater knowledge of particular site conditions, installation requirements, and the like.

However, many of our customers have great success installing our panels using suspension installation systems (e.g., French cleats) which continue to be the most common installation system for our paneling systems.

Monarch® Z-Clips and other forms of cleats providing a suspension installation system have become an industry-preferred method installation systems because of their ease of use, and flexibility to accommodate various installations that allow panels to move in response to ordinary changes in ambient environmental conditions such as heat and humidity. Although mechanical fasteners may be used to install panels, special care must be taken not to hinder panel movement in response to ambient environmental changes.

Regardless of the type of installation system you ultimately choose, please always remember that it's always best to "measure twice, but cut once," specially for fastener placement. Inappropriately placed fasteners of any type can exert unequal pressure on the panels, causing excessive or uneven panel movements during periods of dimensional change due to ambient environmental changes, or even causing cracks or other structural failures.

3.1 Monarch® Z-Clips – Suspension Installation System: We recommend that prior to any installation you review various instructional material available through the Monarch Metal webpage www.monarchmetal.com for detailed specifications and instructions for use of various Z Clips as may be appropriate for your particular installation needs. Monarch also provides a short video (http://www.monarchmetal.com/wp-content/uploads/2013/03/all_01.mp4) generally displaying various elements of the Monarch Z

Clip suspension system for installation of wall panels. See Diagram below for a general overview:

Monarch makes many types of Z Clips to accommodate a range of suspension systems. Although the ultimate choice of the installation system used is subject to the installer's discretion, many customers typically rely on the Monarch like Z-Clip MF625 in installations (see Diagram below). Please see the Monarch website, at <http://www.monarchmetal.com/products/z-clips/> for the whole range of Monarch Z Clip options available prior to finalizing your choice.

Overview

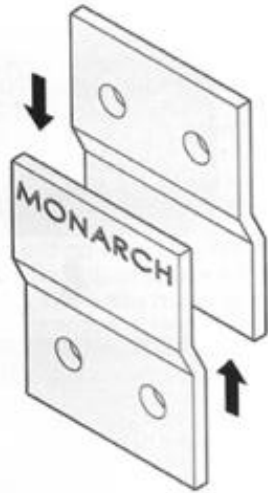

Monarch Metal has provided the fastest and easiest method to mount wall panels, signs, art work and more for close to 25 years.

The key advantages of the Monarch Z Clip system are:

- Simplicity of installation
- Strength and security of the mounting
- No visible screws or nails on the surface of the mounted panel

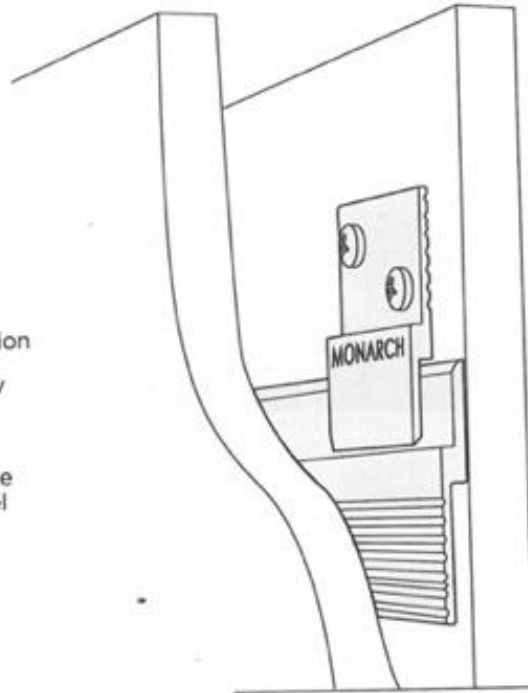

MF625 Clip

Standard Z Clips

Features

- Monarch Z Clip system for hanging interior panels where the installer desires a 5/8" length of engagement
- 3/4" clearance required between the top of the panel and the ceiling
- 6063-T6 Aluminum

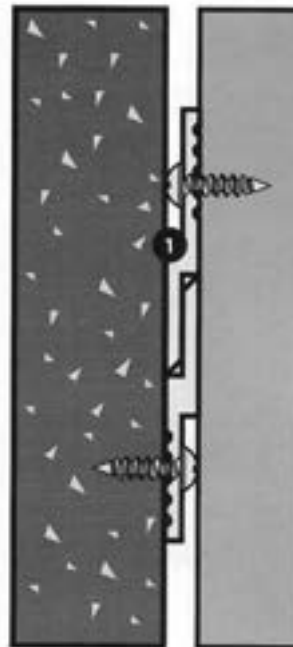

1 MF625 Clip

Standard Applications
5/8" Lift Off
3/16" Projection

FEATURES

	MF625
Material	Aluminum
Stock Clip Size	1 1/2 Inch
Stock Continuous Length	72 Inch, 144 Inch
Custom Lengths Available	Any
Lift Off (1)	5/8 Inch
Projection (2)	3/16 Inch
Availability	Same Day Shipping

(1) The "Lift-Off" is the amount you need to raise the panel over its resting height to mount the panel.

(2) The "Projection" is the distance that the panel sits out from the wall.

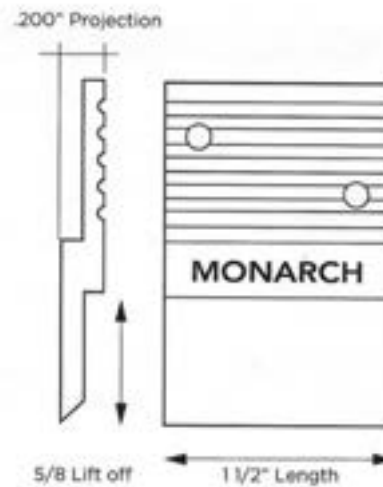

Monarch typically recommends using twelve (12) stock-length Z Clips (typically about 51mm in length) evenly spaced across the width of each panel, and for some installations this may be the preferred method. But Z Clips are also available in many other lengths and may be cut to size and drilled on site as well. In many cases an easier installation for Durapalm panels may be achieved through the use of four (4) continuous length Z Clips, each approximately 1.07m in length, evenly spaced across the back of a panel and spanning the width. Each of these “Z-bars” may further be painted to facilitate a hidden suspension system.

The Z-bar continuous length clips can come with pre-drilled screw holes, and additional holes may be made in the field by drilling through the aluminum Z-bar as needed to align with the optimal screw hold positions on the back of the Durapalm panel, with a minimum of 6 screws per 1.07m Z-bar continuous length clip being used. The optimal screw hold position on the back of the Linear Sound Panel is a point centered between both the horizontal and vertical perforation cuts of the particular design.

3.2 Installation Tips for Monarch® Z-Clips: The first Z-bar continuous length clip should be centered horizontally approximately 76mm in from both vertical edges (left, right) and approximately 51mm from the top edge of the panel. At this time, determine if the pre-drilled holes on the Z-bar align with the optimal screw hold positions on the panel and adjust positioning of the Z-bar as needed from the top of the panel. If additional holes are needed, mark the Z-bar with an indelible marker at the desired points. Evenly space the remaining (3) Z-bars continuous length clips, working down the panel, with approximately 30” between each row of the Z-bar clips. The bottom Z-bar clip should, like the top Z-bar clip, be spaced approximately 2” from the bottom of the panel.

Before drilling or setting screws in the panel, lay the Z-bar continuous length clips in their proper position and draw a pencil line along the top edge of the Z-bar clip onto the back of the panel, while marking the positions of the Z-bar clip holes as well. Using a 3.2mm drill bit, drill into the back of the panel at your penciled in holes to a depth of approximately 6.35mm depending on the design, being cautious NOT TO DRILL THROUGH the face of the panel.

Now set the Z-bar continuous length clip carefully into place per your pencil markings and using an #8 x 12.7mm Stainless Steel panhead Phillips, self-tapping screw, fasten the Z-bar into place using the pre-drilled holes. Note as the depth of the screws are minimal, it is best to screw these in by hand to make sure of proper placement and torque on the screws.

Measure and hang Z Clips on the wall as needed for jobsite conditions and proper panel placement, taking care of the proper orientation and placement of the panels according to applicable architectural specifications and field measurements.

3.3 Providing Adequate Standoff for Sound Abatement Applications: In order to accommodate the installation of acoustic backing material (e.g., our QuietWall backing material,) the installed panel should project off the panel by approximately an inch or more.

This standoff will allow the placement of acoustical backing material behind the panel, for example by affixing the acoustic abatement material directly to the wall using an adhesive like a Loctite P11 type construction adhesive.

You can then proceed with your installation, for example by using a standoff Z-clip and Z-bar (See Diagram MFEXT1250.) Alternatively furring strips can be used to provide a 25.4mm standoff and low profile Z-clips can be inserted. Installing the Z-clips on the wall then applying the acoustical fiberglass to the wall works best, with the panels hung on the existing Z-Clip installation, sandwiching the acoustical backing material between the wall and the back of the panel.

MFEXT-1250

Specialty Z Clips

Features

- Monarch Z Clip system for hanging interior panels where the installer desires a 1 1/4" or 1 3/8" projection
- 3/4" clearance required between the top of the panel and the ceiling
- 6063-T6 Aluminum

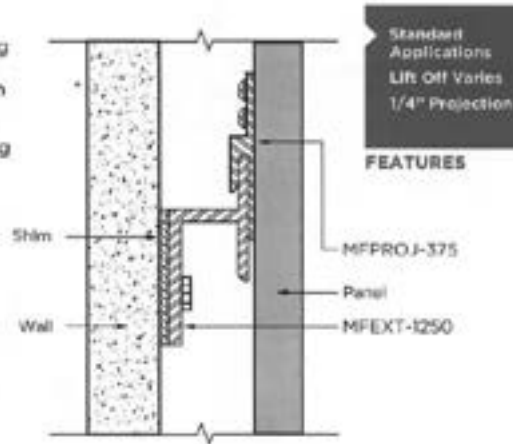

MONARCH Z CLIPS

MFEXT-1250	
Material	Aluminum
Stock Clip Size	Mates with MFTH-625 or MFPROJ-375
Stock Continuous Length	120 inch
Custom Lengths Available	Any
Lift Off (1)	7/8 inch
Projection (2)	1 3/8 inch or 3/8 inch
Availability	Same Day Shipping

(1) The "Lift-Off" is the amount you need to raise the panel over its resting height to mount the panel.

(2) The "Projection" is the distance that the panel sits out from the wall.

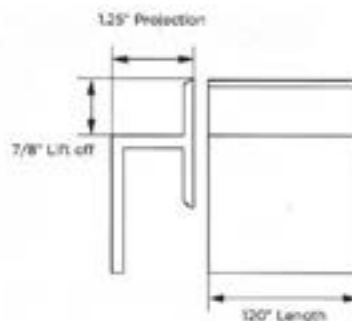

Tips for Horizontal Panel Installation: Although our panels are typically installed in a vertical orientation, they may also be suitable for horizontal installation subject to your ability to provide adequate installation safeguards. Panels can be mounted horizontally if proper support through an engineered wall system is provided during installation. To help you determine whether to attempt a horizontal installation, please consider the following installation information.

In vertical installations, the ridged design (i.e., the high ribbing of the Linear Profiles and the Tahiti, Marrakesh, Sandakan styles) of the DWS panels supports the panel, providing ridged support and stiffening the panel when installed, for example by being locked into French cleats. With this panel design, the high face ribbing of the panel is running perpendicular to the installation system to provide the ridged support.

Using the Tahiti, Marrakesh, and Sandakan style panels as an example, in a horizontal installation the high ribbing is instead running parallel to the installation system, with this greatly reducing structural support for the panel, impairing the rigidity of the panel. The result will be a wavy vertical appearance unless additional vertical support is provided.

To provide a successful horizontal installation, suitable vertical stiffening must be attached to the wall, or the panel, or preferably both, to provide a ridged vertical support. Consider affixing additional vertical supports to the wall, running perpendicular to the running perpendicular to the high face ribbing of the panel. One of the ways to achieve additional support is to insert vertical supports in-between the installation fasteners, and consider using spot cleats, pre-drilled and inserted into the core. Additional vertical support can also be applied to the back of the panel using stiffening bars on the back of the panel prior to installation. Stiffening bars are commonly used in such applications and can be low profile and well placed to avoid interference with the installation hardware.

Exercise great care in placement of the installation hardware because it is important for DWS panels to "top hang" in a horizontal installation such that the installation cleat located on the top is fully engaged with the panel, and the installation cleat on the bottom is also fully engaged, not "short" or pushing up on the panel from the bottom. If the panels are not properly seated and engaged with both the top and bottom cleats, the panel may come to rest on the bottom cleat, hence having a tendency for the entire panel weight to rest on the bottom cleat, with this causing a billowing or "pushing out" of the panels. This is a particularly important requirement for panels with aggressive face cuts, such as the Linear Profiles and Acoustic Systems panel products.

Additional Support for Horizontal Joints: Exercise care to support horizontally installed panels with furring strips applied to the joint areas of such an installation. This furring strip should force the panel proud off the wall, and line up with the protrusion of the Z-bars to counter the natural tendency of the panels to curve inward at the edges. **Since the edges are running the length of a horizontal and edges are long, they may be visually intrusive if not supported.**

4. Trim Options for Walls and Ceilings



Durapalm Trim for Decorative Panels

Create a smooth transition between adjoining panels or a finish detail with DurapalmTrim.

DurapalmTrim profiles are:

- Single-ply; Prefinished on three sides
- Available in all Signature* colors
- Offered in lengths of 2.438m or 3.05m
- Grain direction runs the length

**TRIM
PROFILES**



19mm x 19mm

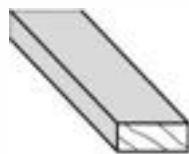

19mm x 51mm

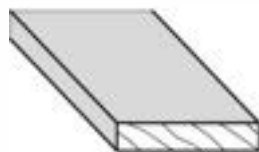

19mm x 100mm

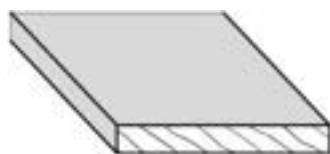

19mm x 152.4mm

**OUTSIDE CORNER
PLAN DETAIL**

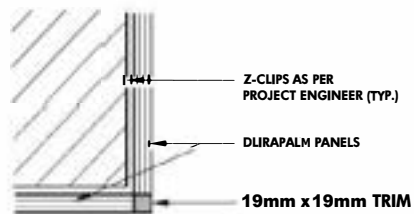

**PERIMETER TRIM / BASEBOARD
SECTION DETAILS**

